

Compact Hydrostatic Drive Unit

HYDROTRAC GFT - M2

with Fixed and Variable
Displacement Motors
for Two-speed Operation

Description

The travel drive HYDROTRAC GFT M2 is specially designed for applications which require smooth travel at low speeds. It has also the ability to operate at higher speeds during maneuvering. Road pavers e.g. are one of these applications.

For this purpose the drive is equipped with both a variable and fixed displacement motor. The fixed-displacement motor can be disconnected or can be allowed to act on the gearbox together with the variable displacement motor.

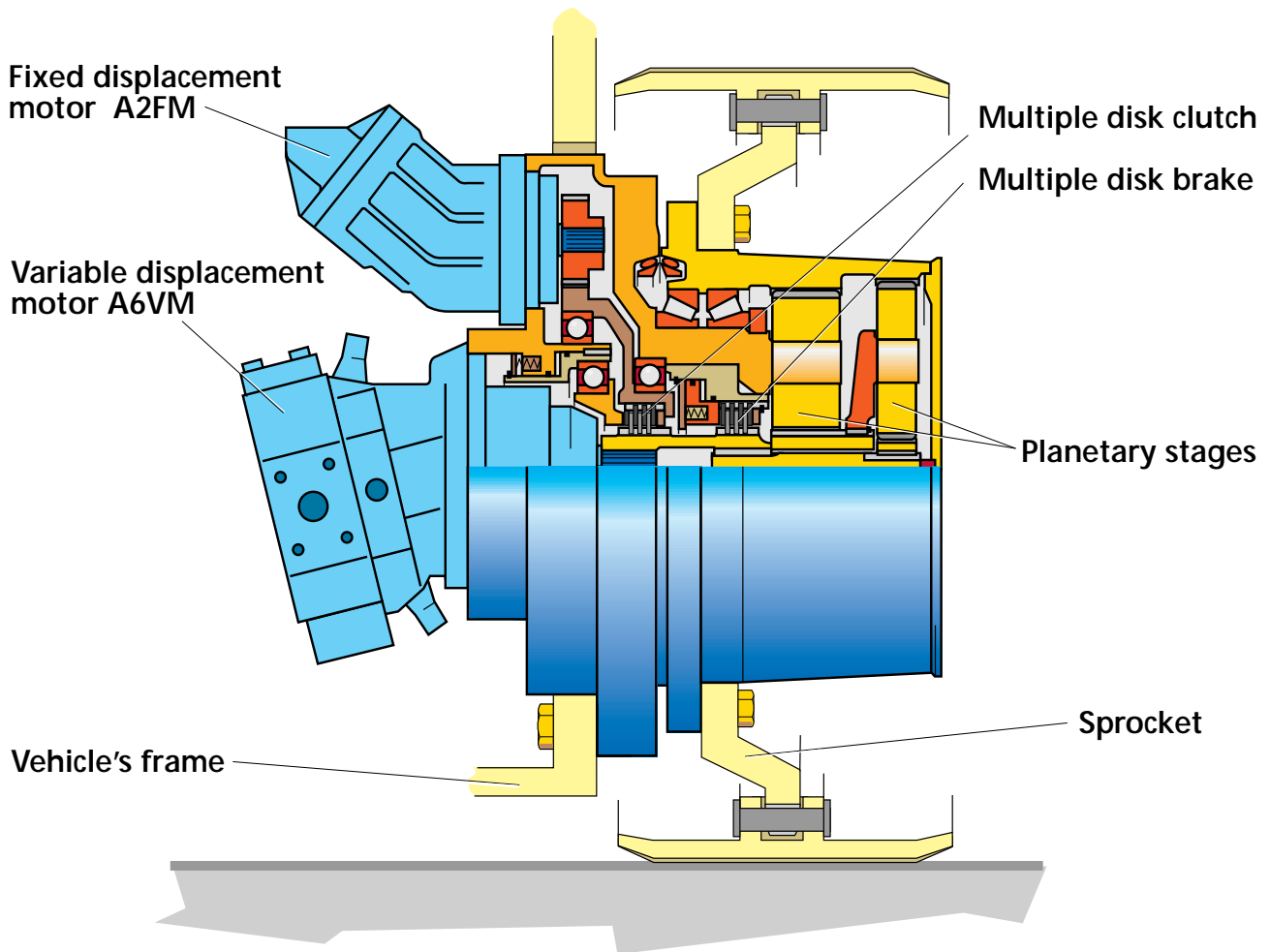

Operation with Variable Displacement Motor
 Enables high travelling and maneuvering speed rates. The fixed displacement motor is switched off.

Operation with Variable and Fixed Displacement Motor
 Low traversing speed rates with high output torques and smooth running characteristics. The variable displacement motor is switched off.

GFT 24 M2

Gearbox weight: 175 kg

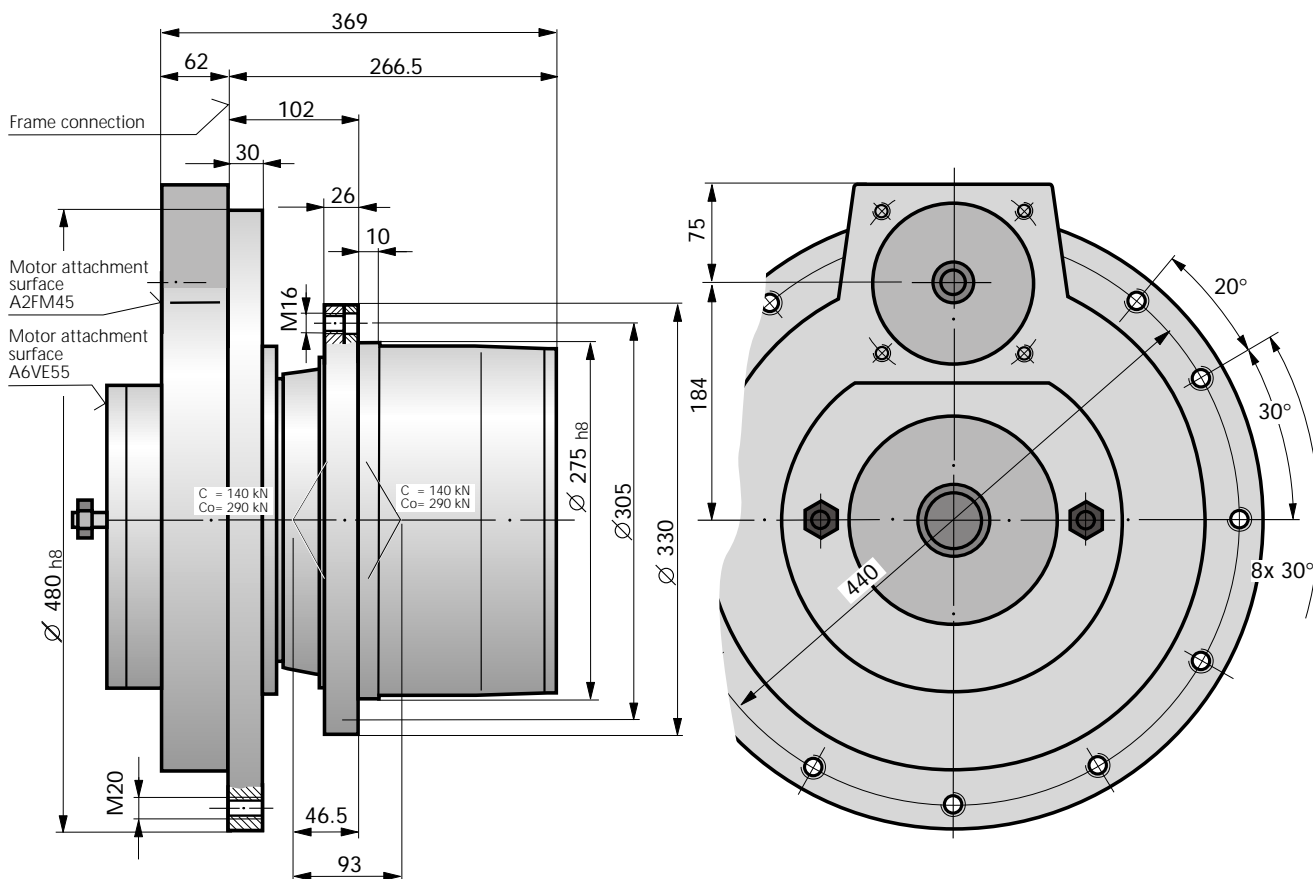
**Technical Data**(theoretical values, without consideration of η_{mech} and η_v ; values rounded)**GFT 24 M2 - A6VE 55**

Transmission ratio	i	36.97
Motor displacement	$V_{g \max}$ cm ³	54.8
	$V_{g \min}$ cm ³	0.0
Max. torque of parking brake	T_{Br} Nm	650
Total displacement	$V_{g \text{ total}}$ cm ³ /rev.	2026
Motor speed at $V_{g \max}$	n_1 rpm	4450
Motor speed at $V_g < V_{g1}$	n_1 rpm	5000
	V_{g1} cm ³ /rev.	35
Output speed at $V_{g \max}$	n_2 rpm	120.4
Output speed at $V_g < V_{g1}$	n_2 rpm	135.2
Inlet flow rate at n_{\max}	$q_{v \max}$ l/min	244
Differential pressure	Δp bar	450
Motor torque	$T_{1 \max}$ Nm	392
Output torque	$T_{2 \max}$ Nm	14495

GFT 24 M2 - A2FM 45

Transmission ratio	i	149.42
Motor displacement	$V_{g \max}$ cm ³	45.6
Max. torque of parking brake	T_{Br} Nm	650
Total displacement	$V_{g \text{ total}}$ cm ³ /rev.	6813
Motor speed at $V_{g \max}$	n_1 rpm	4200
Output speed at $V_{g \max}$	n_2 rpm	28.1
Inlet flow rate at n_{\max}	$q_{v \max}$ l/min	192
Differential pressure	Δp bar	222
Motor torque	$T_{1 \max}$ Nm	161
Output torque	$T_{2 \max}$ Nm	24000

GFT 35 M2

Gearbox weight: 240 kg

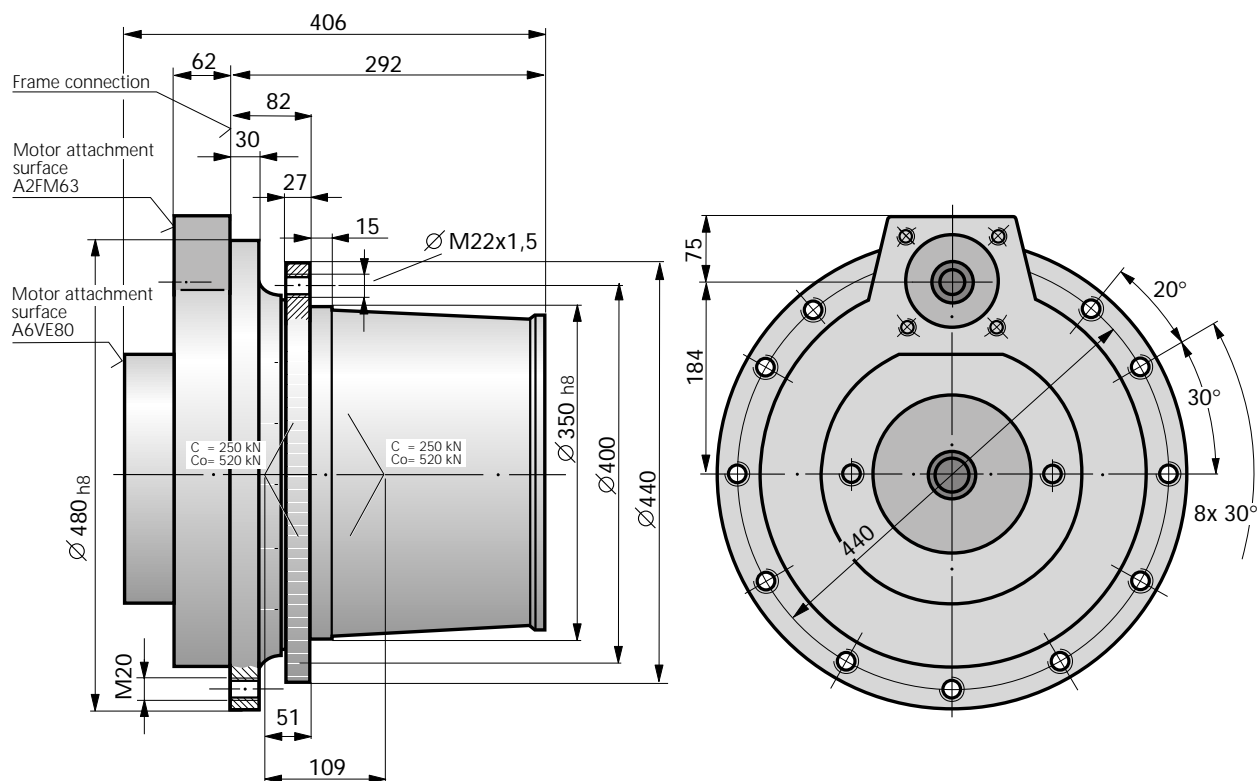
**Technical Data**(theoretical values, without consideration of η_{mech} and η_v ; values rounded)**GFT 35 M2 - A6VE 80**

Transmission ratio	i	55.00
Motor displacement	$V_{g \max}$ cm ³	80.0
	$V_{g \min}$ cm ³	0.0
Max. torque of parking brake	T_{Br} Nm	650
Total displacement	$V_{g \text{ total}}$ cm ³ /rev.	4400
Motor speed at $V_{g \max}$	n_1 rpm	3900
	n_1 rpm	5000
	V_{g1} cm ³ /rev.	51
Output speed at $V_{g \max}$	n_2 rpm	70.9
	n_2 rpm	90.9
Inlet flow rate at n_{\max}	$q_{v \max}$ l/min	312
Differential pressure	Δp bar	450
Motor torque	$T_{1 \max}$ Nm	572
Output torque	$T_{2 \max}$ Nm	31482

GFT 35 M2 - A2FM 63

Transmission ratio	i	222.29
Motor displacement	$V_{g \max}$ cm ³	63.0
Max. torque of parking brake	T_{Br} Nm	650
Total displacement	$V_{g \text{ total}}$ cm ³ /rev.	14004
Motor speed at $V_{g \max}$	n_1 rpm	4200
Output speed at $V_{g \max}$	n_2 rpm	18.9
Inlet flow rate at n_{\max}	$q_{v \max}$ l/min	265
Differential pressure	Δp bar	180
Motor torque	$T_{1 \max}$ Nm	180
Output torque	$T_{2 \max}$ Nm	40000

Our production program for mobile equipment

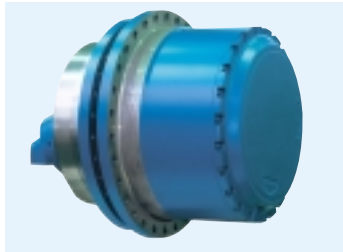

Hydrostatic Drives

- HYDROTRAC GFT for the traversing and movement of mobile equipment, with integrated hydraulic motors of Hydromatik make, and multiple-disk parking brake.

Output torques
from 2 to 9 kNm

See catalog RE 77109

Output torques
from 13 to 330 kNm

See catalog RE 77110

Output torques
up to 2100 kNm
on request

Hydrostatic Swing Gears

- MOBILEX GFB primarily for use in all types of excavators, cranes and rotatable equipment.

Output torques
up to 650 kNm

See catalog RE 77201

- MOBILEX GFB Swing gears equipped with Hydraulic motor A10 FD.
See catalog RE 77204

Winch Drives

- MOBILEX GFT – W for the space-saving integration into winch drums.
Available drive configurations
 - with end supporting bearing
 - with winch support
 - with rope drum

for rope pull forces of
up to 2000 kN

See catalog RE 77502